

Our Solutions

Marine | Audio Solutions - October 2022

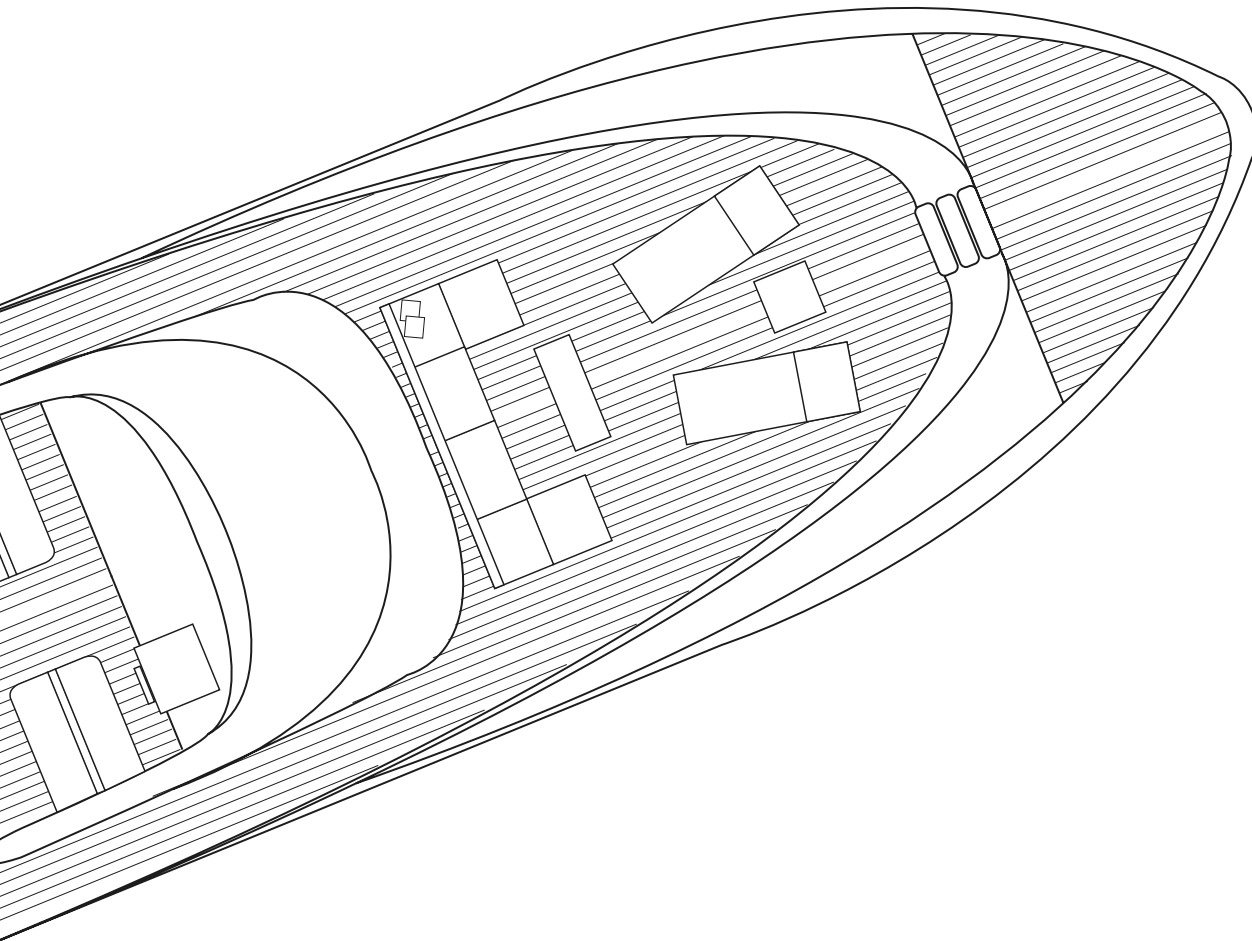

Marine | Audio Solutions

Bring The Quality Of Live Concert Sound On Board

With over 30 years of experience in the research of professional audio, K-array's manufacturing knowledge has developed specific protections and treatments for its unique audio solutions, to suit marine applications.

The result is a catalog of products dedicated exclusively for "Marine" projects where corrosion can limit design ambitions and most often compromise on sound quality.





BIG CHALLENGES WHEN THE SEA ATTACKS

The selection of the K-array Marine products have passed through very stressing tests in salt haze room. Our R&D department made very big improvements in materials, painting, accessories and various treatments that distinguish these premium products from the regular ones.



TREATMENTS

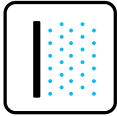

RESISTING AGAINST SALT CORROSION

- An epoxy-based CATHAPHORESIS treatment is applied by electroplating on all K-array's Marine products, ensuring a total coating with a homogeneity of constant thickness in order to give metal surfaces a considerable resistance to chemical and environmental corrosion.
- Nano-powders of Zirconium are used in the formation of phosphate coatings to improve corrosion resistance and paint durability.
- Different joining accessories and screws are used to resist corrosion
- Chassis made of only premium materials like AISI304 stainless steel



BEING WATER PROOF

- IP accessories are always included and features an epoxy-based CATHAPHORESIS pre-paint treatment.
- In some products the connectors have been replaced by built-in cable gland.
- The cone drivers have been waterproof and UV-proof treated

OUTDOORS

Paging and Public address

Audio solutions that provide clear background audio can be customized from room to room for Paging and Public Address applications, allowing the crew to provide emergency notifications or simply information for passengers.

Entertainment

Music has always been a part of life at sea for centuries. Nowadays, traditional sea shanties have turned into elegant and trendy soundtracks. Powerful and high-quality background music can help entertain passengers during long crossings making the travel much more comfortable and fun. That includes getting ready to party too, once you drop your anchor or dock somewhere.



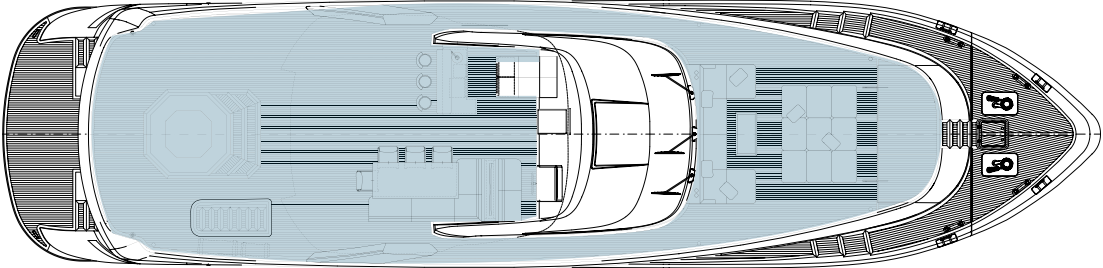

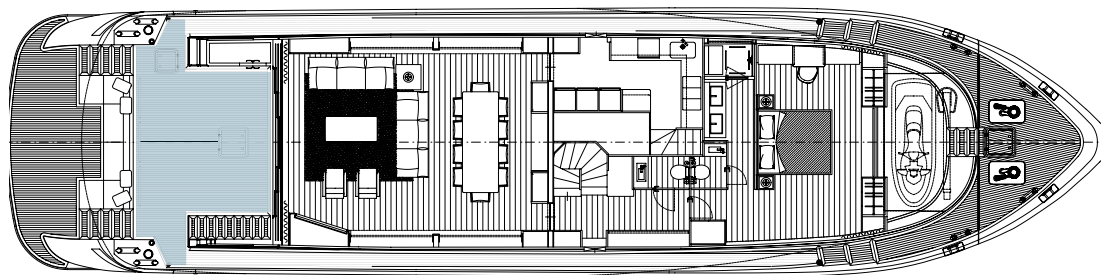

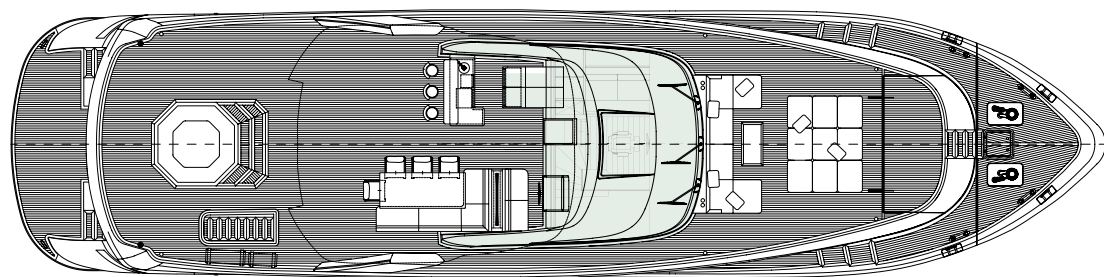



Vyper II

The Vyper line consists of the flattest speakers in the K-array portfolio and are housed in an elegant and resistant 0".9-deep aluminum frame that features closely-spaced transducers which boast Pure Array Technology that allows to cover venues uniformly and provide long throw, demonstrating true line array characteristics: phase coherence, low distortion and focused listening in both the near field and at a distance from the speaker. For optimal integration with every K-array amplifier model, the speaker features a selectable impedance. at HIGH impedance, a large amount of speakers can be driven by a single amp channel.

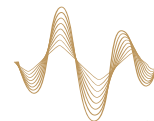

Vyper-KV25M II



Vyper-KV25RM II

General

Type	Line array
Transducers	4 x 1" neodymium magnet woofers
Frequency Response	150 Hz - 18 kHz (-6 dB)
Max SPL	108 dB (peak)
Rated Power	75 W
Coverage	V. 25° H. 140°
Connectors	2PIN euroblock connector (included)
Nominal Impedance	8 Ω / 32 Ω selectable



IP65
accessory
included

Handling & Finishes

Dimensions (WxHxD)	KV25M 40 x 260 x 22 mm (1.6 x 10.2 x 0.9 in) KV25RM 50 x 270 x 37 mm (1.95 x 10.63 x 1.45 in)
Weight	KV25M 0.4 Kg (0.88 lb) KV25RM 0.4 Kg (0.88 lb)
Material	Aluminum
Colors	Black, White, Custom RAL
IP Rating	IP65



Black



White



Custom RAL





Vyper II

Ultra-flat aluminum line array element

SPEAKERS

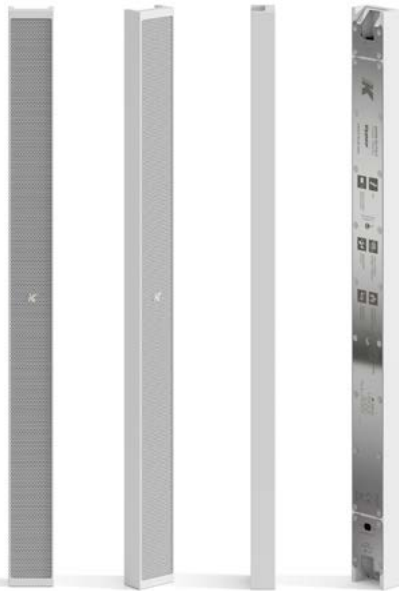

Vyper-KV52M II

General

Type	KV52 Line array KV52F Point Source
Transducers	8 x 1" neodymium magnet woofers
Frequency Response	150 Hz – 18 kHz (-6 dB)
Max SPL	114 dB (peak)
Rated Power	150 W
Coverage	KV52 V, 10° H, 140° KV52F V, 120° H, 140°
Connectors	2PIN euroblock connector (included)
Nominal Impedance	16 Ω / 64 Ω selectable

Vyper-KV52RM II

Handling & Finishes

Dimensions (WxHxD)	KV52M 40 x 500 x 22 mm (1.6 x 19.7 x 0.9 in) KV52RM 50 x 510 x 37 mm (1.95 x 20.08 x 1.45 in)
Weight	KV52M 0.8 Kg (1.54 lb) KV52RM 0.8 Kg (1.54 lb)
Material	Aluminum
Colors	Black, White, Custom RAL
IP Rating	IP65

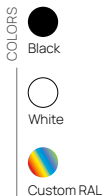

IP65
accessory
included

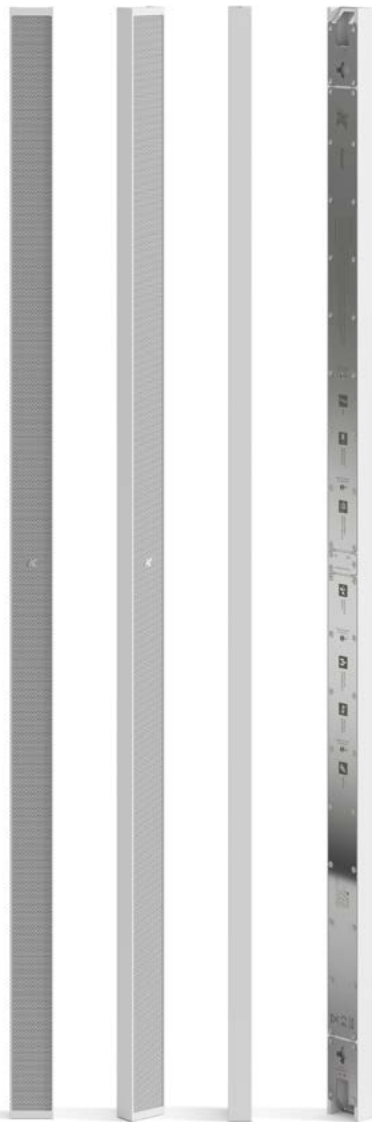
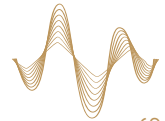

Vyper-KV102M II

General

Type	Line array
Transducers	16 x 1" neodymium magnet woofers
Frequency Response	150 Hz - 18 kHz (-6 dB)
Max SPL	120 dB (peak)
Rated Power	300 W
Coverage	V. 7° I.H. 140°
Connectors	2PIN euroblock connector (included)
Nominal Impedance	8 Ω / 32 Ω selectable



IP65
accessory
included



Vyper-KV102RM II

Handling & Finishes

Dimensions (WxHxD)	KV102M 40 x 1000 x 22 mm (1.6 x 39.3 x 0.9 in) KV102RM 50 x 1010 x 37 mm (1.95 x 39.76 x 1.45 in)
Weight	KV102M 1.8 Kg (3.96 lb) KV102RM 1.8 Kg (3.96 lb)
Material	Aluminum
Colors	Black, White, Custom RAL
IP Rating	IP65



Custom RAL





Kobra

The Kobra line is a great example of K-array's unique performance-to-size ratio employed in its product design. The passive speakers feature closely-spaced 2" transducers housed in a sleek, durable stainless steel frame and boast Pure Array Technology that produces natural quality and powerful sound with two different models, varying in length.



Selectable **Impedance**

Selectable impedance lets the user to choose the right loudspeaker impedance value allowing to set the proper load and maximize performance.

Selectable **Coverage**

The directivity of many K-array solutions can be modified in order to optimize the coverage. Our column loudspeakers are equipped with a regulator with two coverage options: SPOT for very narrow sound dispersion and FLOOD for wider coverage.



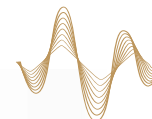

Kobra-KK52M I

General

Type	Line array
Transducers	8 x 2" neodymium magnet woofers
Frequency Response	150 Hz - 18 kHz (-6 dB)
Max SPL	120 dB (peak)
Rated Power	200 W
Coverage	V. 10° - 60° H. 120°
Connectors	Cable gland with 7 meter long wire
Nominal Impedance	16 Ω / 64 Ω selectable

Handling & Finishes

Dimensions (WxHxD)	59 x 497 x 81 mm (2.3 x 19.6 x 3.2 in)
Weight	2.3 kg (5.07 lb)
Material	Stainless Steel
Colors	Black, White, Custom RAL
IP Rating	IP65

Raccomanded Accessories



Kobra-KK102M I

General

Type	Line array
Transducers	16 x 2" neodymium magnet woofers
Frequency Response	150 Hz - 18 kHz (-6 dB)
Max SPL	126 dB (peak)
Rated Power	400 W
Coverage	V. 7° - 35° H. 120°
Connectors	Cable gland with 7 meter long wire
Nominal Impedance	8 Ω / 32 Ω selectable

Handling & Finishes

Dimensions (WxHxD)	59 x 1000 x 81 mm (2.3 x 39.4 x 3.2 in)
Weight	4.8 kg (10.6 lb)
Material	Stainless Steel
Colors	Black, White, Custom RAL
IP Rating	IP65

Raccomanded Accessories

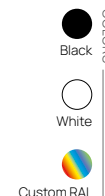

Python

The Python is a discreet passive speaker comprised of 3.15" drivers housed in a resistant stainless steel frame rendering it resistant to corrosion, rust or stain - perfect for a great variety of both indoor and outdoor applications. The Python line contains two sizes: a half meter-long model, KP52 I, and meter-long model, KP102 I, and can reproduce the whole vocal frequency range with high intelligibility.



Selectable Impedance

Selectable impedance lets the user to choose the right loudspeaker impedance value allowing to set the proper load and maximize performance.

Selectable Coverage

The directivity of many K-array solutions can be modified in order to optimize the coverage. Our column loudspeakers are equipped with a regulator with two coverage options: SPOT for very narrow sound dispersion and FLOOD for wider coverage.



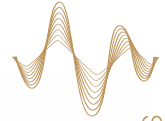

Python-KP52M I

General

Type	Line array
Transducers	6 x 3.15" neodymium magnet woofers
Frequency Response	120 Hz - 18 kHz (-6 dB)
Max SPL	128 dB (peak)
Rated Power	360 W
Coverage	V. 10° - 45° H. 90°
Connectors	Cable gland with 7 meter long wire
Nominal Impedance	8 Ω / 32 Ω selectable

Handling & Finishes

Dimensions (WxHxD)	89 x 520 x 118 mm (3.5 x 20.5 x 4.7 in)
Weight	5.8 kg (12.78 lb)
Material	Stainless Steel
Colors	Black, White, Custom RAL
IP Rating	IP65

Raccomanded Accessories



Python-KP102M I

General

Type	Line array
Transducers	12 x 3.15" neodymium magnet woofers
Frequency Response	120 Hz - 18 kHz (-6 dB)
Max SPL	134 dB (peak)
Rated Power	720 W
Coverage	V. 7° - 30° H. 90°
Connectors	Cable gland with 7 meter long wire
Nominal Impedance	4 Ω / 16 Ω selectable

Handling & Finishes

Dimensions (WxHxD)	89 x 1000 x 118 mm (3.5 x 39.4 x 4.7 in)
Weight	12.0 kg (26.5 lb)
Material	Stainless Steel
Colors	Black, White, Custom RAL
IP Rating	IP65

Raccomanded Accessories



Custom RAL



Kayman

Like the Kobra and the Python lines, the Kayman line is an advanced line array with a sleek design in a stainless steel frame. A passive speaker comprised of closely-spaced, full-range sound sources, the Kayman boasts our innovative Pure Array Technology with its 4" neodymium magnet transducers.



Selectable Impedance

Selectable impedance lets the user to choose the right loudspeaker impedance value allowing to set the proper load and maximize performance.

Selectable Coverage

The directivity of many K-array solutions can be modified in order to optimize the coverage. Our column loudspeakers are equipped with a regulator with two coverage options: SPOT for very narrow sound dispersion and FLOOD for wider coverage.



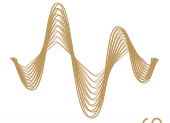

Kayman-KY52M

General

Type	Line array
Transducers	4 x 4" neodymium magnet woofers
Frequency Response	120 Hz - 20 kHz (-6 dB)
Max SPL	132 dB (peak)
Rated Power	600 W
Coverage	V. 7° - 30° H. 90°
Connectors	Cable gland with 7 meter long wire
Nominal Impedance	4 Ω / 16 Ω selectable

Handling & Finishes

Dimensions (WxHxD)	
Weight	
Material	Stainless Steel
Colors	Black, White, Custom RAL
IP Rating	IP65

Raccomanded Accessories



Kayman-KY102M

General

Type	Line array
Transducers	8 x 4" neodymium magnet woofers
Frequency Response	120 Hz - 20 kHz (-6 dB)
Max SPL	138 dB (peak)
Rated Power	1200 W
Coverage	V. 7° - 30° H. 90°
Connectors	Cable gland with 7 meter long wire
Nominal Impedance	8 Ω / 32 Ω selectable

Handling & Finishes

Dimensions (WxHxD)	116 x 1000 x 134 mm (4.6 x 39.4 x 5.3 in)
Weight	14.9 kg (32.8 lb)
Material	Stainless Steel
Colors	Black, White, Custom RAL
IP Rating	IP65

Raccomanded Accessories

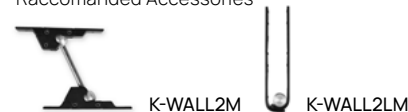



Domino

Our full-range line of compact, stainless steel speakers with plug and play capabilities that don't require presets and can be driven by any amplifier, perfect for applications with subwoofer restrictions. The speakers are comprised of two neodymium magnet drivers coaxially mounted plus a passive radiator to extend the bass response in the lower end frequencies.



Domino-KFC26M

General

Type	Point source
Transducers	6" neodymium magnet woofer 2" neodymium magnet woofer 6" passive transducer
Frequency Response	50 Hz - 20 kHz (-6 dB)
Max SPL	115 dB (peak)
Rated Power	160 W
Coverage	V. 140° H. 140°
Connectors	4PIN euroblock connector (included)
Nominal Impedance	8 Ω
Sensitivity (1W,1m)	90 dB

Handling & Finishes

Dimensions (WxHxD)	180 x 350 x 118 mm (7.1 x 13.8 x 4.6 in)
Weight	6.5 kg (14.3 lb)
Material	Stainless Steel
Colors	Black, White, Custom RAL
IP Rating	IP64



K-KUIP
is the IP64
protection cover
(included)

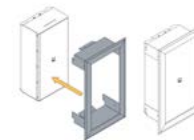

FLUSHED WALL MOUNTING
The Domino can be easily
flush mounted into the wall
thanks to the **K-WFM**
accessory (not included).



Domino-KF210M

General

Type	Point source
Transducers	10" neodymium magnet woofer 3" neodymium magnet woofer 10" passive transducer
Frequency Response	40 Hz - 19 kHz (-6 dB)
Max SPL	123 dB (peak)
Rated Power	320 W
Coverage	V. 90° H. 90°
Connectors	4PIN euroblock connector (included)
Nominal Impedance	4 Ω / 16 Ω
Sensitivity (1W,1m)	95 dB

Handling & Finishes

Dimensions (WxHxD)	282 x 500 x 151 mm (11.1 x 19.7 x 5.9 in)
Weight	12 kg (26.5 lb)
Material	Stainless Steel
Colors	Black, White, Custom RAL
IP Rating	IP64



K-KUIP
is the IP64
protection cover
(included)

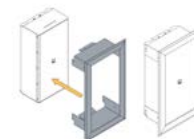

FLUSHED WALL MOUNTING
The Domino can be easily
flush mounted into the wall
thanks to the **K-WFM**
accessory (not included).





Rumble

Extremely compact, yet powerful bass systems, The Rumble subwoofer line is engineered for maximum linear excursion and minimum residual noise that boast extended low frequency response.

The subs are made entirely of steel, making them extremely resistant, even when deployed outside in tough weather conditions. This is ideal for water-front environments where ordinary bass speakers would corrode. They are impenetrable by foreign objects like dust, sand or water, which over time can damage an ordinary audio element.

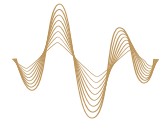

Rumble-KU44M

General

Type	Passive subwoofer
Transducers	2 x 4" neodymium magnet woofers 2 x 4" passive radiator
Frequency Response	45 Hz - 150 / 500 Hz (-6 dB)
Max SPL	116 dB (peak)
Rated Power	120 W
Coverage	Omni
Connectors	4PIN euroblock connector (included)
Nominal Impedance	8 Ω / 32 Ω selectable

Handling & Finishes

Dimensions (WxHxD)	500 x 116 x 100 mm (19.7 x 4.6 x 4.0 in)
Weight	5.9 kg (13.0 lb)
Material	Stainless Steel
Colors	Black, White, Custom RAL
IP Rating	IP64



K-KUIP4 is the IP64 protection cover (included)

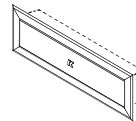

FLUSHED WALL MOUNTING

The Rumble can be easily flush mounted into the wall thanks to the **K-WF44M** accessory (not included).

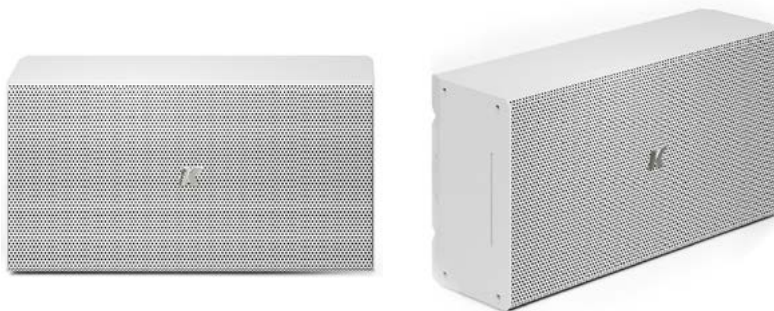

Rumble-KU26M

General

Type	Passive subwoofer
Transducers	6" neodymium magnet woofers 6" passive radiator
Frequency Response	45 Hz - 150 / 500 Hz (-6 dB)
Max SPL	121 dB (peak)
Rated Power	160 W
Coverage	Omni
Connectors	4PIN euroblock connector (included)
Nominal Impedance	8 Ω / 32 Ω selectable

Handling & Finishes

Dimensions (WxHxD)	350 x 180 x 118 mm (13.8 x 7.1 x 4.6 in)
Weight	5.9 kg (13.0 lb)
Material	Stainless Steel
Colors	Black, White, Custom RAL
IP Rating	IP64



K-KUIP is the IP64 protection cover (included)

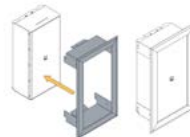

FLUSHED WALL MOUNTING

The Rumble can be easily flush mounted into the wall thanks to the **K-WFM** accessory (not included).



Custom RAL



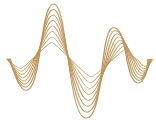

Rumble

Stainless steel passive subwoofers

Marine | Audio Solutions

SUBWOOFERS



Rumble-KU210M

General

Type	Passive subwoofer
Transducers	10" neodymium magnet woofer 10" passive radiator
Frequency Response	40 Hz – 150 Hz (-6 dB)
Max SPL	127 dB (peak)
Rated Power	320 W
Coverage	Omni
Connectors	4PIN euroblock connector (included)
Nominal Impedance	4 Ω / 16 Ω selectable

Handling & Finishes

Dimensions (WxHxD)	500 x 282 x 151 mm (19.7 x 11.1 x 5.9 in)
Weight	11 kg (24.3 lb)
Material	Stainless Steel
Colors	Black, White, Custom RAL
IP Rating	IP64

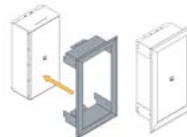
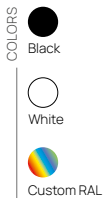

FLUSHED WALL MOUNTING

The Rumble can be easily flush mounted into the wall thanks to the **K-WFM** accessory (not included).

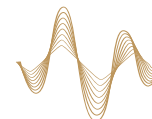

Rumble-KU212M

General

Type	Passive subwoofer
Transducers	12" neodymium magnet woofer 12" passive radiator
Frequency Response	35 Hz – 150 Hz (-6 dB)
Max SPL	130 dB (peak)
Rated Power	700 W
Coverage	Omni
Connectors	4PIN euroblock connector (included)
Nominal Impedance	4 Ω / 16 Ω selectable

Handling & Finishes

Dimensions (WxHxD)	655 x 330 x 200 mm (25.8 x 13.0 x 7.9 in)
Weight	18.5 kg (40.8 lb)
Material	Stainless Steel
Colors	Black, White, Custom RAL
IP Rating	IP64



K-KUIP12
is the IP64
protection cover
(included)





Anakonda

When we talk about UNIQUE AUDIO SOLUTIONS the Anakonda line is the first one that comes to mind as it's the most revolutionary speaker in our product portfolio.

It is designed as a problem solver for situations where a traditional speaker box can't be used, but where good intelligibility, ultra-reliability and a sleek design are required.

The Anakonda series is designed as a problem solver for situations where a traditional speaker box can't be used, but where good intelligibility, ultra-reliability and a sleek design are required. A FLEXO® PET-grade braid exterior permits the speaker to bend into any seamless shape that you desire.

Joining more than one modular Anakonda units you can create long lines of continuous clear sound to reach a desired length and guarantee a perfect coverage.

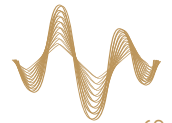

Anakonda-KAN200+8M

General

Type	Line array
Transducers	16 x 1" neodymium magnet woofer
Frequency Response	150 Hz - 18 kHz (-6 dB)
Max SPL	108 dB (peak)
Rated Power	300 W
Coverage	V. 10° H. 140°
Connectors	SpeakOn NL4 1+ 1- (signal); 2+ 2- (through)
Nominal Impedance	8 Ω

Handling & Finishes

Dimensions (WxHxD)	2000 (±20 mm) x 56 x 35 mm (79.5 (±0.8 in) x 2.2 x 1.4 in)
Weight	1.9 kg (4.2 lb)
Material	PVC/Neoprene
Colors	Black, White
IP Rating	IP64



K-IP65KITA (included)



K-IP65KITB (included)





INDOORS

Sound Masking (for your wellbeing)

A Sound Masking system delivers the feeling of being surrounded by a bubble of sound, while being isolated from background noises and unwanted irritations. Specifically curated sounds provide the level of privacy desired, covering up unwanted annoying noises. K-array can support you to design the sound system you need, using the best technologies, respecting your style and taste with the most discreet solutions ever seen or heard before.

Entertainment

With a wealth of experience in the pro live audio industry we bring our knowledge and design to the home theatre with **ATMOS/Dolby certification**. That means you can go from a luxury home entertainment application to a powerful and dynamic party mood in any space. K-array products can provide the same quality sound of a club or a cinema, keeping maximum respect for the interior or exterior design. Impress your guests with the most compact systems. Don't leave the great sound onshore. Having high-quality fun onboard has never been so easy!

Background music

Enjoy richly detailed sound control in several rooms of your boat with K-array seamless connectivity. Powered by intelligence, your K-array sound system is now managed by the Integrated Electronic Brain - IEB - implemented into all the latest electronics. More than a traditional DSP, the built-in micro electronics driven by the integrated operating system osKar features expansive sound processing, offering complete user control over the system performance, EQ, dynamic filters and an 8x8 routing matrix.

The dedicated Software and the App provide the possibility to manage all the functions of the amplifier, from sound source selection and playlist management to graphic equalization and multi-room network setup.



View products on:
issuu.com/k-array/docs/residential

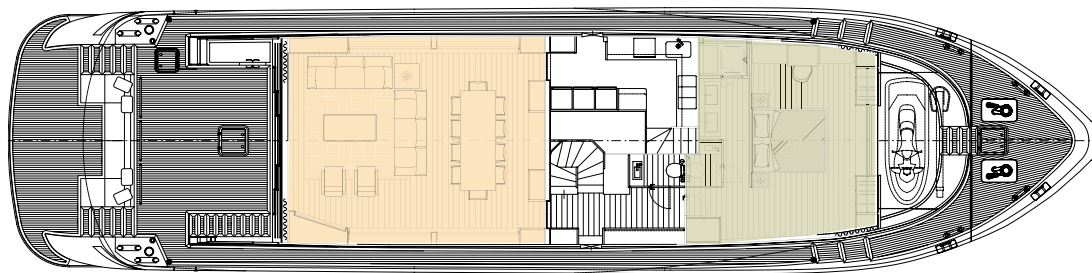

View products on: issuu.com/k-array/docs/residential

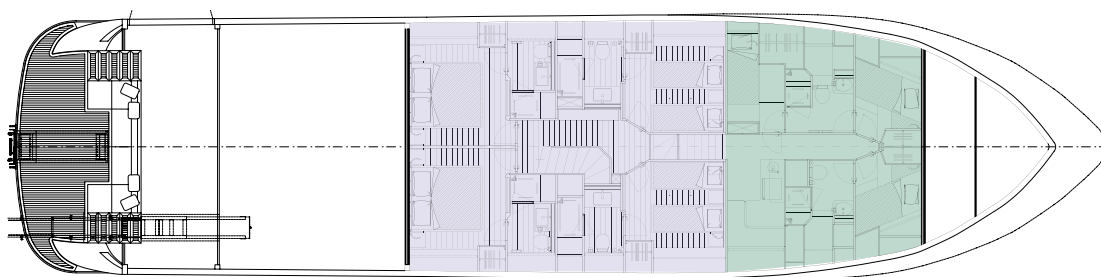

View products on: issuu.com/k-array/docs/residential

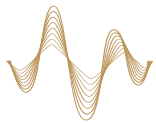

Kommander

All-in-one stainless steel amplifiers and processing solutions

AMPLIFIERS

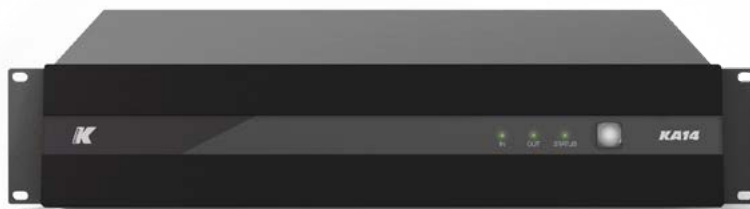

View products on: issuu.com/k-array/docs/residential

Marine | Audio Solutions

Kommander-KA02 I

General

Type	4ch switching mode, Class D Amplifier
Output Power	4x 50W @ 4Ω
Impedance	minimum 4 Ω (2 Ω PBTL)
Frequency Response	20 Hz - 20 kHz (±1 dB)
Connections	Input: 4x BAL input: Euroblock 1.5/ 3-ST-3.81, 3.5 mm jack unBAL analog stereo AUX input, TOSLINK optical input, Output: 2x Euroblock 2.5/ 4-G-5.08 Digital: 4x USB-A 2.0, 1x RJ45 Ethernet, Bluetooth 4.1 Low Energy, Wi-Fi IEEE 802.11 b/g/n
Built-in DSP	Grouping, Input EQ, Output EQ, Signal Routing, Level adjustment, Dynamic Limiters
Remote control	Wi-Fi dedicated K-array Connect mobile app. Ethernet wired K-framework3 multiplatform design and tuning software
Protections	Over Temp. (Power Limiting - Thermal Shutdown), Short Circuit/Overload Output Protection, Power Limiting, Clip Limiter/Permanent Signal Limiter, High Frequency Protection
MAINS Operating Range	Dedicated AC/DC power adapter 100-240V ~ AC, 50-60 Hz input / 24 V, 4 A DC output
Power Consumption	20 W @ 4 Ω load, Pink noise, 1/8 rated power

Handling & Finishes

Color	Black
Material	Aluminum
IP Rating	IP20
Dimensions (WxHxD)	219 x 45,5 x 170 mm (8.6 x 1.8 x 6.7 in)
Weight	0.7 kg (1.5 lb)

Kommander-KA14 I

General

Type	4ch switching mode, Class D Amplifier
Output Power	4x 600W @ 2Ω
Impedance	minimum 2 Ω
Frequency Response	20 Hz - 20 kHz (±1 dB)
Connections	Input: 4x XLR-F bal input 4x XLR-M bal LINK output Output: 2x PC 4/ 4-ST-7,62 speaker output Remote connectivity: 1x Ethernet RJ45 4x USB-A Wi-Fi IEEE 802.11 b/g/n Power: 1 x PowerCon TRUE IN 1 x PowerCon TRUE Link
Built-in DSP	Grouping, Equalization, Limiters, Routing, Level, Loudspeaker presets
Remote control	Wi-Fi and Ethernet dedicated APP and Desktop software
Protections	Thermal protection, output short circuit, RMS output current protection, high frequency protection, power limiter, clip limiter.
MAINS Operating Range	100-240V AC, 50-60 Hz with PFC
Power Consumption	400 W @ 4 Ω load, Pink noise, 1/8 rated power

Handling & Finishes

Color	Black
Material	Stainless Steel
IP Rating	IP20
Dimensions (WxHxD)	430 x 87 x 430 mm (17 x 3,4 x 17 in)
Weight	6 kg (13,2 lb)

The product performance data shown here is a first reference. We strongly advise that you download the latest datasheet online at www.k-array.com

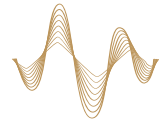

Kommander-KA18

General

Type	8ch switching mode, Class D Amplifier
Output Power	8 x 150W @ 4Ω
Impedance	minimum 4 Ω
Frequency Response	20 Hz – 20 kHz (±1 dB)
Connections	Input: 8x XLR-F bal input Output: 4x PC 4/ 4-ST-7,62 speaker output Remote connectivity: 1x Ethernet RJ45 4x USB-A Wi-Fi IEEE 802.11 b/g/n Power: 1 x PowerCon TRUE IN 1 x PowerCon TRUE Link
Built-in DSP	Grouping, Equalization, Limiters, Routing, Level, Loudspeaker presets
Remote control	Wi-Fi and Ethernet dedicated APP and Desktop software
Protections	Thermal protection, output short circuit, RMS output current protection, high frequency protection, power limiter, clip limiter.
MAINS Operating Range	100-240V AC, 50-60 Hz with PFC
Power Consumption	400 W @ 4 Ω load, Pink noise, 1/8 rated power

Handling & Finishes

Color	Black
Material	Stainless Steel
IP Rating	IP20
Dimensions (WxHxD)	430 x 87 x 430 mm (17 x 3,4 x 17 in)
Weight	7 kg (15,4 lb)



Kommander-KA28

General

Type	8ch switching mode, Class D Amplifier
Output Power	8 x 600W @ 2Ω
Impedance	minimum 2 Ω
Frequency Response	20 Hz – 20 kHz (±1 dB)
Connections	Input: 8x XLR-F bal input Output: 4x PC 4/ 4-ST-7,62 speaker output Remote connectivity: 1x Ethernet RJ45 4x USB-A Wi-Fi IEEE 802.11 b/g/n Power: 1 x PowerCon TRUE IN 1 x PowerCon TRUE Link
Built-in DSP	Grouping, Equalization, Limiters, Routing, Level, Loudspeaker presets
Remote control	Wi-Fi and Ethernet dedicated APP and Desktop software
Protections	Thermal protection, output short circuit, RMS output current protection, high frequency protection, power limiter, clip limiter.
MAINS Operating Range	100-240V AC, 50-60 Hz with PFC
Power Consumption	800 W @ 4 Ω load, Pink noise, 1/8 rated power

Handling & Finishes

Color	Black
Material	Stainless Steel
IP Rating	IP20
Dimensions (WxHxD)	430 x 87 x 430 mm (17 x 3,4 x 17 in)
Weight	7,4 kg (16,3 lb)

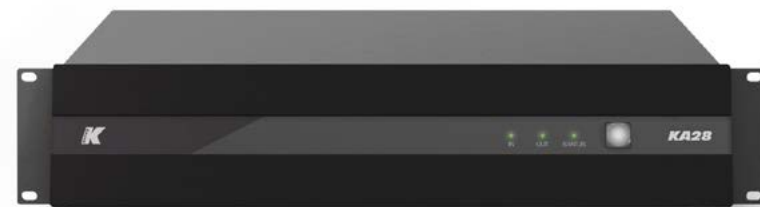

The product performance data shown here is a first reference. We strongly advise that you download the latest datasheet online at www.k-array.com

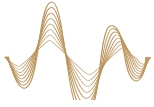

Kommander

All-in-one stainless steel amplifiers and processing solutions

AMPLIFIERS

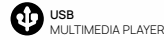

View products on: issuu.com/k-array/docs/residential

Kommander-KA34

General

Type	4ch switching mode, Class D Amplifier
Output Power	4 x 750W @ 4Ω
Impedance	minimum 4 Ω
Frequency Response	20 Hz - 20 kHz (±1 dB)
Connections	Input: 4x XLR-F bal input 4x XLR-M bal LINK output Output: 2x PC 4/ 4-ST-7,62 speaker output Remote connectivity: 1x Ethernet RJ45 4x USB-A Wi-Fi IEEE 802.11 b/g/n Power: 1 x PowerCon TRUE IN 1 x PowerCon TRUE Link
Built-in DSP	Grouping, Input EQ, Output EQ, Signal Routing, Level adjustment, Dynamic Limiters, Delay
Remote control	Wi-Fi and Ethernet dedicated APP and Desktop software
Protections	Thermal protection, output short circuit, RMS output current protection, high frequency protection, power limiter, clip limiter.
MAINS Operating Range	100-240V AC, 50-60 Hz with PFC
Power Consumption	600 W @ 4Ω load, Pink noise, 1/8 rated power

Handling & Finishes

Color	Black
Material	Stainless Steel
IP Rating	IP20
Dimensions (WxHxD)	430 x 87 x 430 mm (17 x 3,4 x 17 in)
Weight	7 kg (15,4 lb)

Kommander-KA68

General

Type	8ch switching mode, Class D Amplifier
Output Power	8 x 750W @ 4Ω
Impedance	minimum 4 Ω
Frequency Response	20 Hz - 20 kHz (±1 dB)
Connections	Input: 8x XLR-F bal input Output: 4x PC 4/ 4-ST-7,62 speaker output Remote connectivity: 1x Ethernet RJ45 4x USB-A Wi-Fi IEEE 802.11 b/g/n Power: 1 x PowerCon TRUE IN 1 x PowerCon TRUE Link
Built-in DSP	Grouping, Equalization, Limiters, Routing, Level, Loudspeaker presets
Remote control	Wi-Fi and Ethernet dedicated APP and Desktop software
Protections	Thermal protection, output short circuit, RMS output current protection, high frequency protection, power limiter, clip limiter.
MAINS Operating Range	100-240V AC, 50-60 Hz with PFC
Power Consumption	1200 W @ 4Ω load, Pink noise, 1/8 rated power

Handling & Finishes

Color	Black
Material	Stainless Steel
IP Rating	IP20
Dimensions (WxHxD)	430 x 87 x 430 mm (17 x 3,4 x 17 in)
Weight	8,3 kg (18,3 lb)

The product performance data shown here is a first reference. We strongly advise that you download the latest datasheet online at www.k-array.com

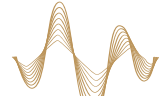

Kommander-KA104

General

Type	4ch switching mode, Class D Amplifier
Output Power	4 x 2500W @ 4Ω
Impedance	minimum 4 Ω (2 Ω tolerant)
Frequency Response	20 Hz – 20 kHz (±1 dB)
Connections	Input: 4x XLR-F bal input 4x XLR-M bal LINK output Output: 2x PC 4/ 4-ST-7,62 speaker output Remote connectivity: 1x Ethernet RJ45 4x USB-A Wi-Fi IEEE 802.11 b/g/n Power: 1 x PowerCon TRUE IN 1 x PowerCon TRUE Link
Built-in DSP	Grouping, Equalization, Limiters, Routing, Level, Loudspeaker presets
Remote control	Wi-Fi and Ethernet dedicated APP and Desktop software
Protections	Thermal protection, output short circuit, RMS output current protection, high frequency protection, power limiter, clip limiter.
MAINS Operating Range	100-240V AC, 50-60 Hz with PFC
Power Consumption	600 W @ 4 Ω load, Pink noise, 1/8 rated power

Handling & Finishes

Color	Black
Material	Stainless Steel
IP Rating	IP20
Dimensions (WxHxD)	430 x 87 x 430 mm (17 x 3,4 x 17 in)
Weight	8,15 kg (18 lb)



Kommander-KA208

General

Type	8ch switching mode, Class D Amplifier
Output Power	8 x 2500W @ 4Ω
Impedance	minimum 4 Ω (2 Ω tolerant)
Frequency Response	20 Hz – 20 kHz (±1 dB)
Connections	Input: 8x XLR-F bal input Output: 4x PC 4/ 4-ST-7,62 speaker output Remote connectivity: 1x Ethernet RJ45 4x USB-A Wi-Fi IEEE 802.11 b/g/n Power: 1 x PowerCon TRUE IN 1 x PowerCon TRUE Link
Built-in DSP	Grouping, Equalization, Limiters, Routing, Level, Loudspeaker presets
Remote control	Wi-Fi and Ethernet dedicated APP and Desktop software
Protections	Thermal protection, output short circuit, RMS output current protection, high frequency protection, power limiter, clip limiter.
MAINS Operating Range	100-240V AC, 50-60 Hz with PFC
Power Consumption	1200 W @ 4 Ω load, Pink noise, 1/8 rated power

Handling & Finishes

Color	Black
Material	Stainless Steel
IP Rating	IP20
Dimensions (WxHxD)	430 x 87 x 430 mm (17 x 3,4 x 17 in)
Weight	10 kg (22 lb)





After 30 years of innovation in the heart of Tuscany, the bespoke nature of our speakers follows a precise, slim, uniform design with quality and performance at the core. A catalog of immersive and invisible audio solutions that can be mounted or installed flush on the wall.

PREMIUM MATERIALS & FINISHES only for indoor applications



K-array utilizes the most durable and resistant materials when developing our products to offer the most reliable solutions on the market. Weather resistant speaker systems made of aluminum and steel make up the frame of all products within the K-array portfolio.

Versatile and efficient, aluminum provides strong structural support without adding excess weight to the products. Naturally generating a protective oxide coating, aluminum is particularly useful for protection and conservation rendering a K-array installation dependable, regardless of the application elements.

Steel is the other functional material K-array implements, which offers corrosion resistance and strength. Stainless steel does not readily corrode, rust or stain with water making those products perfect for aquatic environments as well as traditional settings.

Premium products are also created with high quality luxury finishes made of precious materials, like gold. Additionally, there is a range of colors and finishes that assist in integrating the products into various applications.

Sleek black and elegant white make a subtle statement while a customized color using any RAL code can perfectly match the venue. Also, brushed or polished stainless steel finishes are available which give the product a chameleon-like ability to mirror surrounding surfaces and blend in with the background.

Our quality sound is available in a variety of distinctive finishes that blend beauty with exceptional performance.

ABOUT

K-ARRAY Audio Solutions is globally renowned as one of the most innovative high-technology professional speaker manufacturers in the world founded in Italy. Since the formation of HP Sound Equipment in 1990 and K-ARRAY in 2000 the brand has been pioneering and innovating new audio solutions for live entertainment and the most demanding architectural designs.

K-ARRAY has built on its successful professional audio expertise around the world and expanded the portfolio of solutions for everyday audio needs with KGEAR and combining architectural lighting with KSCAPE. Despite the broadening of the group's business interests, K-ARRAY's goal remains to create unique audio solutions for every application.

WHERE IT BEGAN

In 1990 Alessandro Tatini and his father, Carlo, together with Massimo Ferrati, founded an audio and lighting rental company that offered unique design solutions. Their solutions became legendary while working in theatres, cinemas and town squares and together they realized they could create lightweight speakers that would reduce the high costs, unloading and transporting normally associated with heavy PA systems. Today Alessandro, Carlo and Massimo still continue their work of manufacturing innovative audio solutions with a growing team of over 80 people in the factory at San Piero a Sieve in Italy.

WE INNOVATE

K-array's mission is to innovate the design of audio technology as solutions for all applications without compromising sound quality.

K-array has a catalog of over 300 audio solutions that harness a compact, lightweight and elegant design. We strive to do things better and lead by example right across the brands, understanding that even the smallest, most seemingly insignificant details matter.

THE DIFFERENCE OF BEING AND BEING ON DISPLAY

We take pride that your view is not obstructed by our speakers. Sound quality becomes an invisible, multi-sensory experience capable of integrating audio in contexts where aesthetic compromises are not allowed. The sound comes in all its purity.

WE DO EVERYTHING FOR A REASON

Our expectations of sound quality have changed, so before we embark on any new product creation or project, we must know why we are doing it and be able to create the right amount of impact to evaluate its success.

WE GIVE SPACE, TO YOUR SPACE

K-array's slim solutions always push themselves further. The challenge is to reduce the size of the loudspeakers, while creating an enveloping sound experience.



43°57'00"N-11°22'59.88"E

AN AUTHENTIC PLACE

Mugello. A quaint region in the heart of Tuscany nestled among the Apennine mountains where nature's beauty is exemplified.

This land, which saw the birth of the genius Giotto and the extraordinary entrepreneurial and cultural innovations of the Medici family, has continually renewed over time, integrating itself with the most advanced technologies giving life to achievements recognized throughout the world.

In accordance with its policy of continuous product development, K-array reserves the right to introduce any changes to its products without prior notice. Materials, colors and data presented in the catalog are only for reference. K-array is available to customize systems, finishes and new applications upon request.

All rights reserved © 2022





Designed and Made in Italy

K-ARRAY surl
Via P. Romagnoli 17 | 50038 Scarperia e San Piero - Firenze - Italy
T +39 055 84 87 222 | info@k-array.com

www.k-array.com

